



Sheriff's Office Parking Expansion Future Land Use Change & Rezoning

Neighborhood Workshop

July 22, 2025

Meeting Guidelines

- This meeting is informational only
- It is required as a part of the City of Gainesville review process
- You have been muted upon entering
- If you have a question, either:
 - Unmute yourself to speak
 - Type your question in the chat box

↓ UNMUTE/MUTE

↓ CHAT

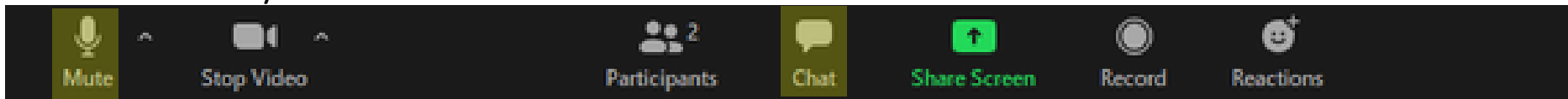

Agenda

- Introductions
- Property Location & Description
- Existing & Proposed Zoning & Land Use Maps
- Next Steps
- Contact Information
- Questions

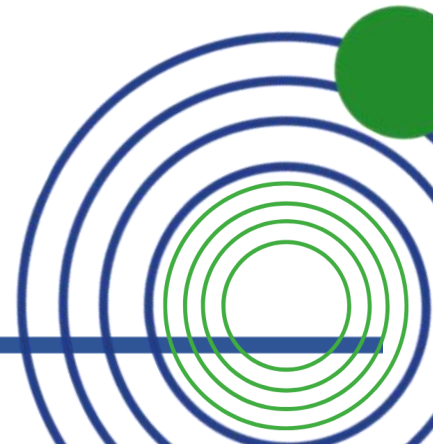

Workshop Mailer

eda consultants, inc.

A neighborhood workshop will be held to discuss a proposed Future Land Use Map change from Single-Family to Public Facilities and a Zoning Map change from Single-Family to Public Services and Operations (PS) on tax parcels 16092-002-000 and 16092-001-000.

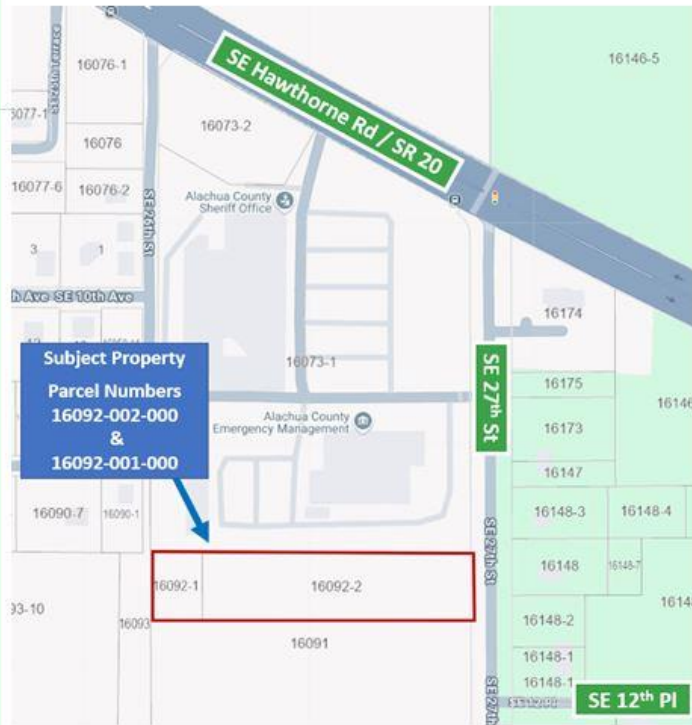

Public Notice of Neighborhood Workshop

Project Name: Alachua County Sheriff's Office
Land Use Change & Rezoning

Project Location: 1124 SE 27th Street on Alachua County Tax
Parcel Numbers 16092-002-000 and 16092-001-000

This is not a public hearing. The purpose of this meeting is to inform members of the public about the application and seek their comments. The meeting will be held virtually as a Zoom teleconference. The teleconference can be accessed by the following information:

Date: Tuesday, July 22, 2025
Time: 6:00 PM
URL: <https://us02web.zoom.us/j/5733319527>
Meeting ID: 573 331 9527
Dial-in by Phone: (646) 558-8656

Following the meeting, a recording of the workshop will be available at www.edafl.com/neighborhoodworkshops. For questions and additional information, please contact:

eda consultants inc.
permitting@edafl.com
352-373-3541

Property Summary

- Location: 1124 SE 27th Street
- Tax Parcel Numbers: 16092-001-000 & 16092-002-000
- Size: Approx. 1.86 +/- Acres

Project Request

1) Land Use Map Change

- From: Single Family
- To: Public Facilities

2) Zoning Change

- From: Single Family (SF)
- To: Public Services & Operations (PS)



Reason for Land Use & Zoning Change

- **Alachua County purchased property for additional parking and building space for the Sheriff's Office**
- **Needs land use & zoning change**
- **New area will provide parking for emergency vehicles & office/maintenance space related to those vehicles & an additional administrative office building**



Location Map

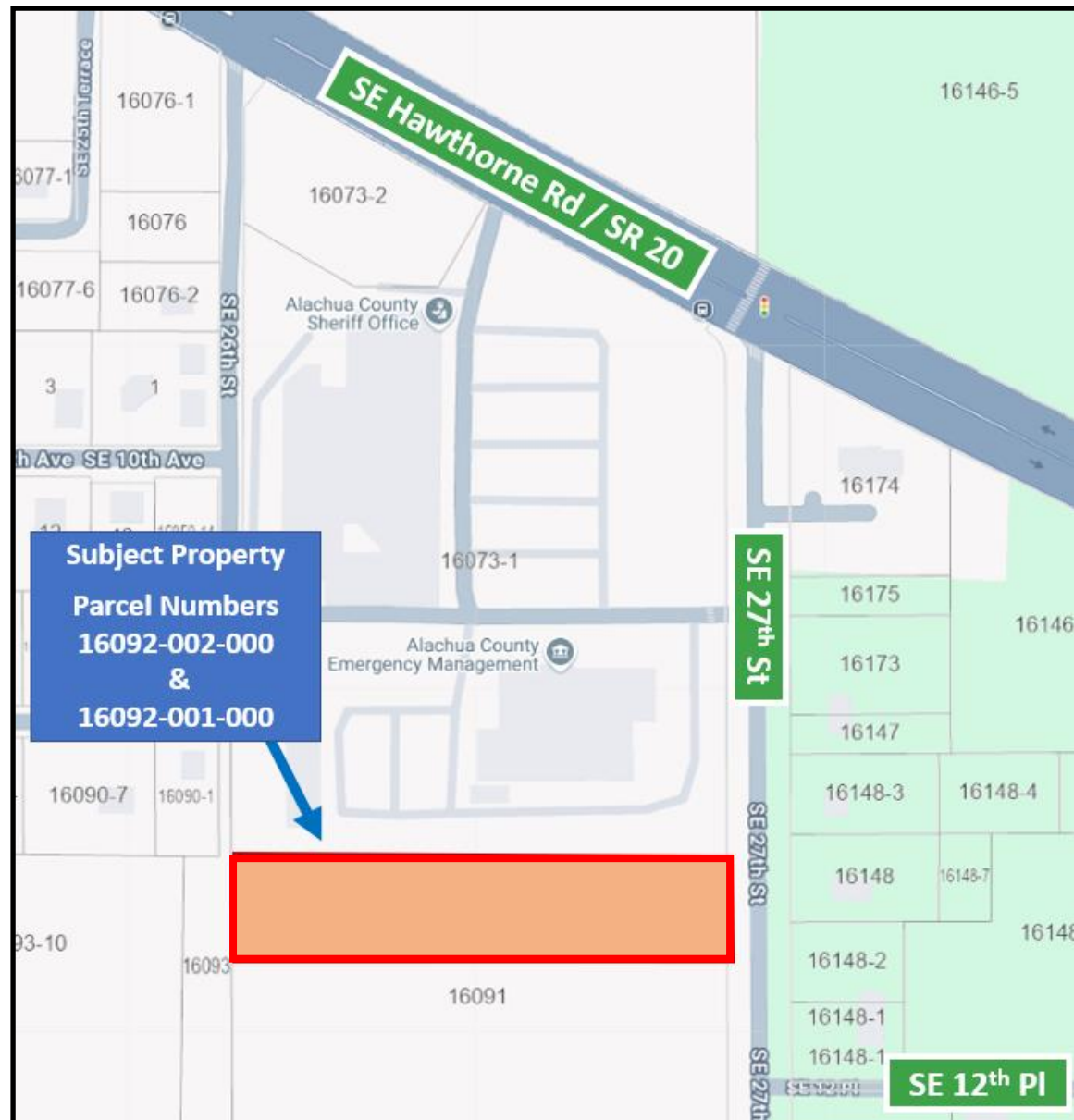

Aerial Map



Future Land Use Map (Existing)

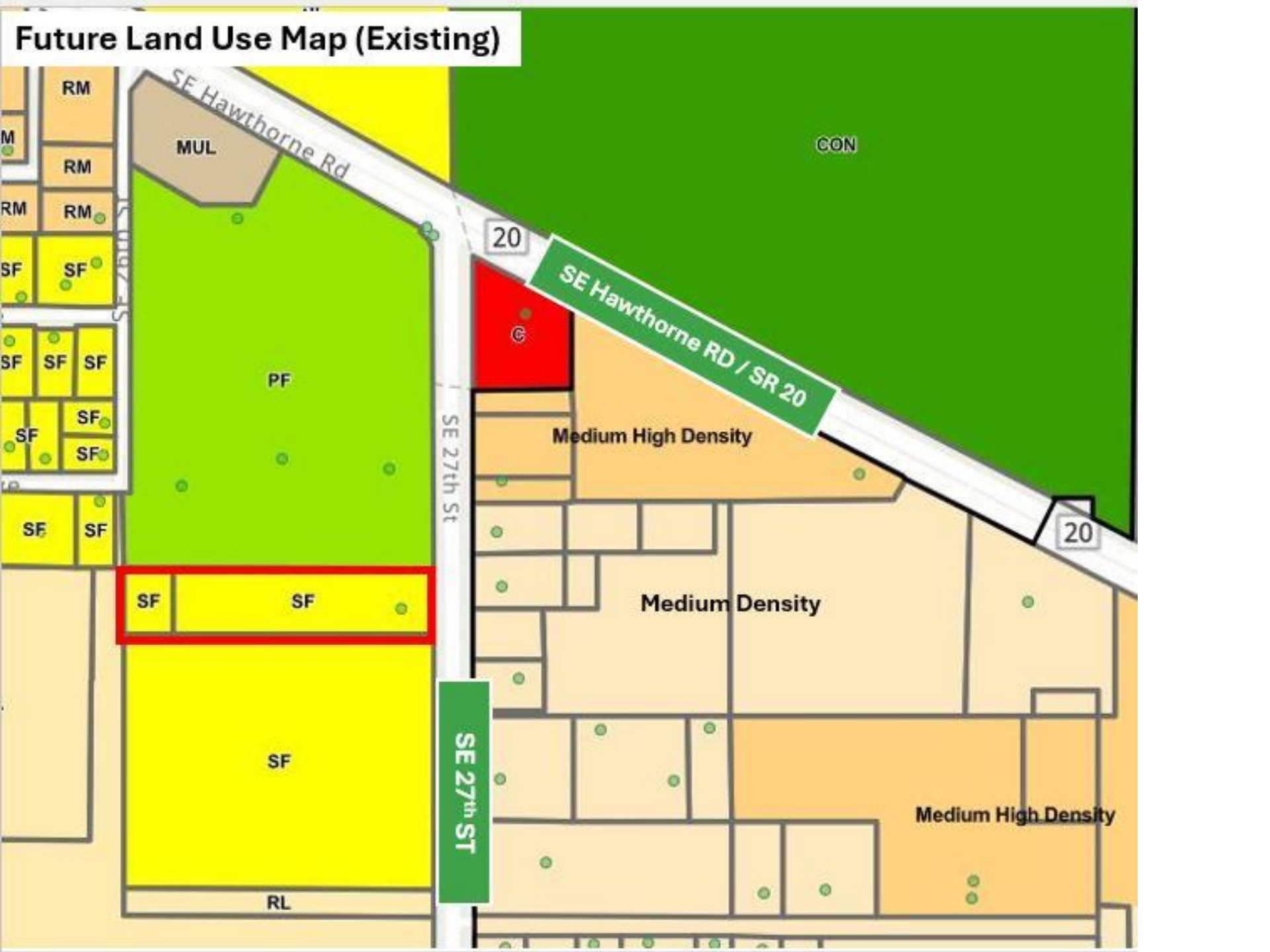

Future Land Use Map (Proposed)

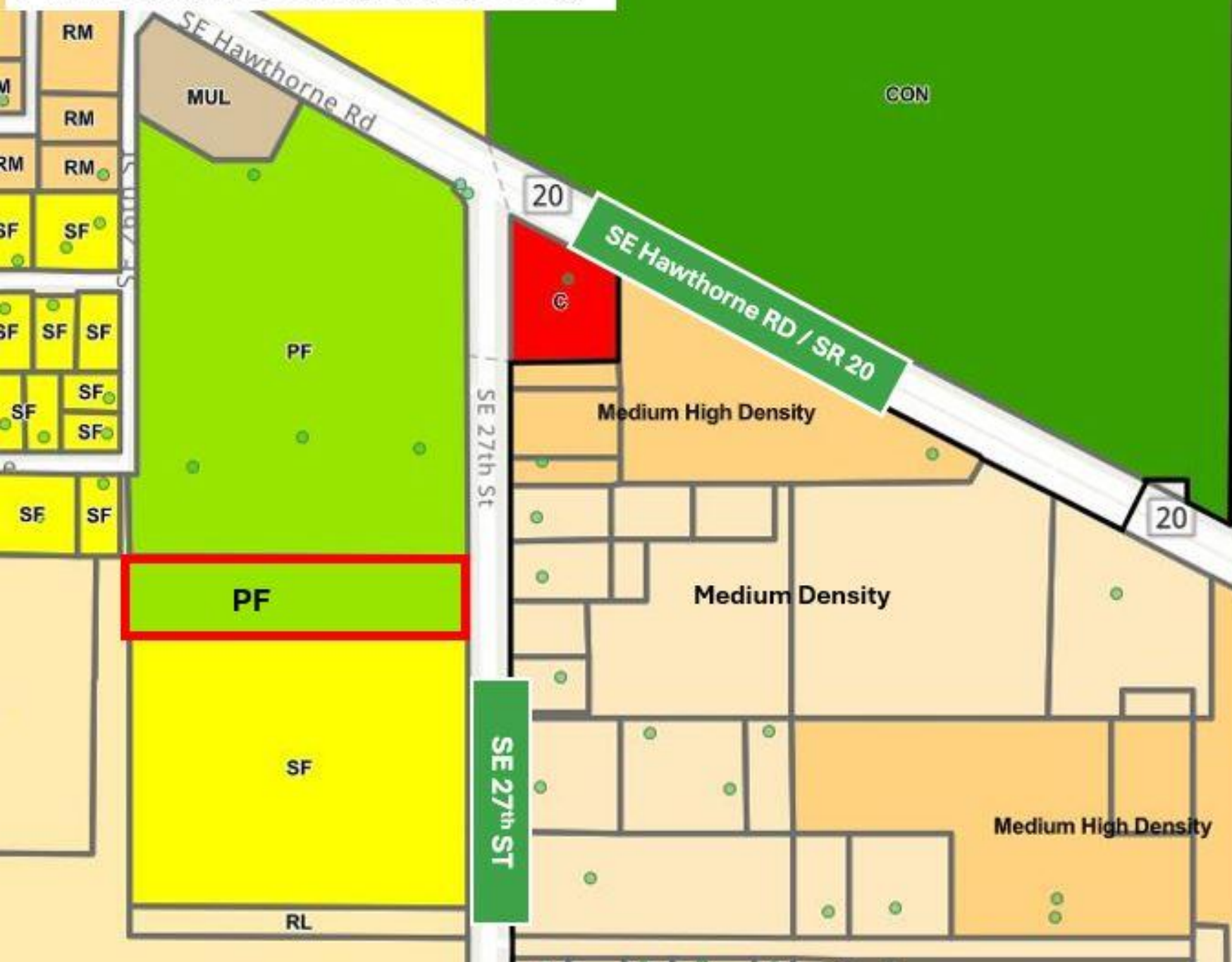

Zoning Map (Existing)



Zoning Map (Proposed)



Conceptual Plan for Sheriff's Office Expansion

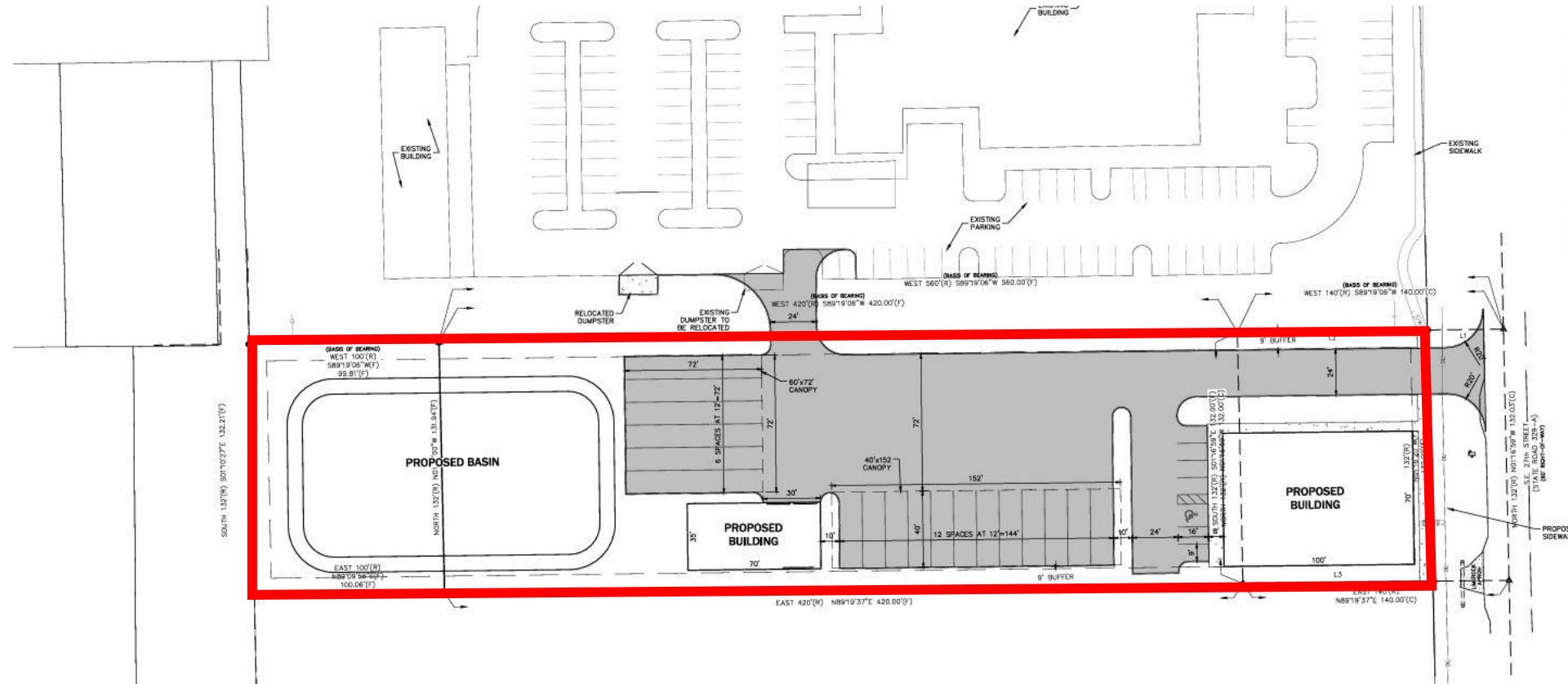

Next Steps

- Neighborhood Workshop – July 22, 2025
- FLU Map Change & Rezoning Applications
 - City Submittal – July 31, 2025 (Tentative)
- Plan Board Public Hearing (TBD)*
- City Commission (TBD)*

*Notices sent to nearby property owners



Presentation will be posted to: <http://edafl.com/neighborhoodworkshops>

Follow-up questions? Email permitting@edafl.com or call 352-373-3541